

OEM Weighing Kit

System components for reliable check weighing



! Benefits

- Comprehensive solution for In-Line checkweighers
- Based on Strain Gauge Technology for mid-range checkweighers
- Proven Minebea Intec design
- Wide variety of components and functionalities in one package



German Quality



Easy Installation



Easy Set-Up



The OEM weighing kit offers high-quality components for integrating a checkweigher into your system or machine. Put your trust in the globally proven weighing technology of Minebea Intec

Integrated checkweigher functionality to fit your solution

- ! All needed components for your In-Line checkweigher in one weighing kit: Indicator, Weighing Table, Feed and Discharge Belt
- ! The Minebea Intec components including the strain gauge load cell will fulfil any customer needs with all checkweigher functionalities and throughputs of up to 120 pieces per minute
- ! Reduce R&D effort and cost by using well-design and proved Minebea Intec checkweigher components
- ! Different load ranges, transport direction and belt sizes available for to offer the comprehensive solution that you need

The right solution for all of these applications:



Classification



Fill quantity control



Statistical process control



Weighing

Technical specifications

Strain gauge OEM Weighing kit

Weighing system	WS 0,6 kg	WS 1,5 kg	WS 3,0 kg	WS 6,0 kg
Weighing range (g)	0...600	0...1500	0...3000	0...6000
Resolution (g)	0,1	0,2	0,5	1,0
Max Throughput (items/min)	120	100	80	80
	Depends on the product, permissible zone of imprecision and ambient conditions			
Speed ranges (m/s)	0,2...1,0			
Belt sizes (center-to-center distance x belt width (mm))	300 x 200	300 x 200 400 x 200	300 x 200 400 x 300 500 x 300	400 x 300 500 x 300
Rollers diameter (mm)	30			
Conveyor	FDA-approved food conveyor belts			
Feed direction	Right to left or left to right (to be indicated when ordering)			
Permissible operating temperature range (°C)	0...+40			
Product temperature (°C)	-30... +80			
Weight	<60 kg			
Power supply for weighing electronics and motors (not included in the scope of delivery)	Minimum power: 24 V / 350 W			
Drivers	Maintenance-free 24 V EC geared motors			
Protection class	Built-In version: depends on the installation situation and customer-side seals Wall-mounted: IP65			

Motor	
Fuse protection per motor	5 A DC slow
Rated voltage (V)	U _{DC} =24 V, brushless motor
Rated current (A)	WS 0,6 kg / WS 1,5 kg: 2,8 WS 3,0 kg / WS 6,0 kg: 4,0
Gearbox	Planetary gearing

Weighing electronics	
Operator terminal input supply voltage (V)	U _{DC} =24 V
Principle	Direct current, Delta-Sigma converter, ratiometric to load cell supply voltage
Conversion time, measurement time (ms)	5, 10, 20, 40, 80, 160, 320, 640, 960, 1200, 1600
Digital filter	Actively parameterisable low pass filter, e. g. 4th order with Bessel, aperiodic Butterworth characteristic Cut-off frequency is automatically determined for each product in Learn mode, can still be optimised manually.

Ambient conditions	
Power-on temperature (°C)	0...+40
Storage/transport (°C)	-20...+70
Air humidity (%)	<95, no condensation (in accordance with IEC 68-2)

Technical diagrams

Operator terminal

Is available in different versions:

- BI: Built-In, for installation in a control cabinet
- WM: Wall Mounted with support bracket

Built-in unit Front and left view

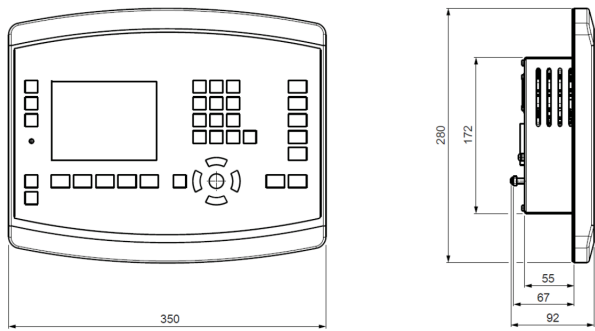

Rear view (connectors board)

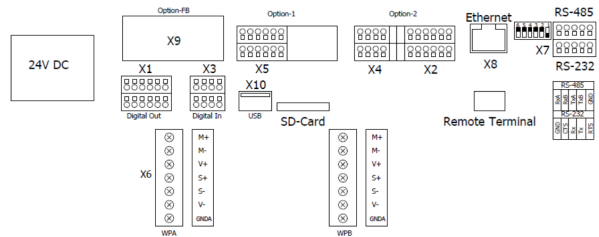

Drilling template for Built-in unit

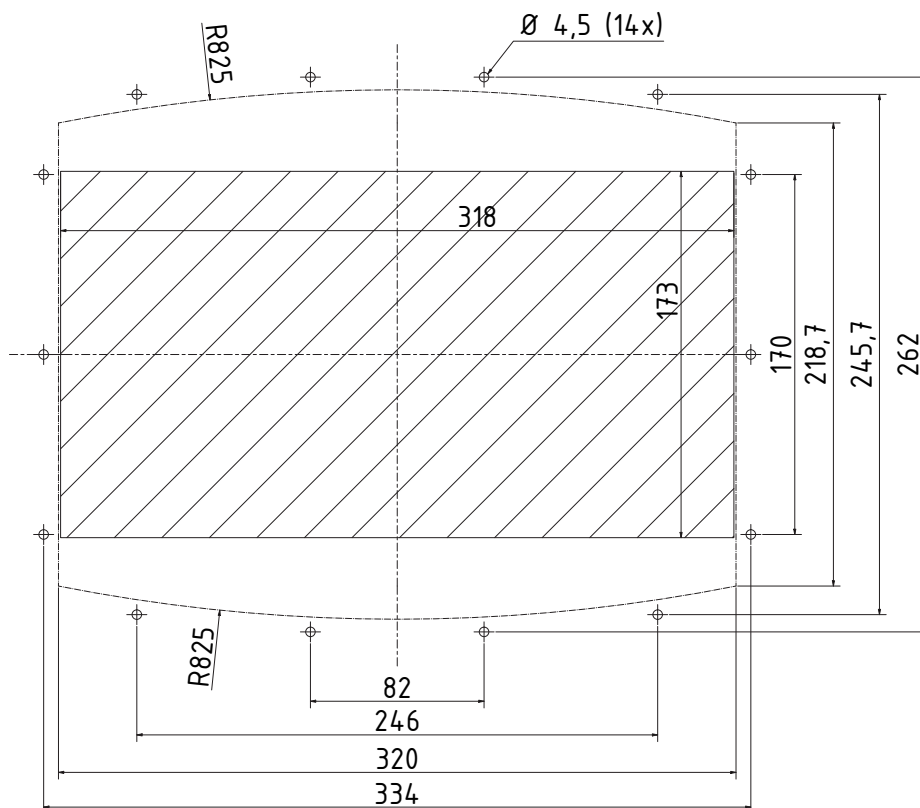

Wall mounting - Front and side view

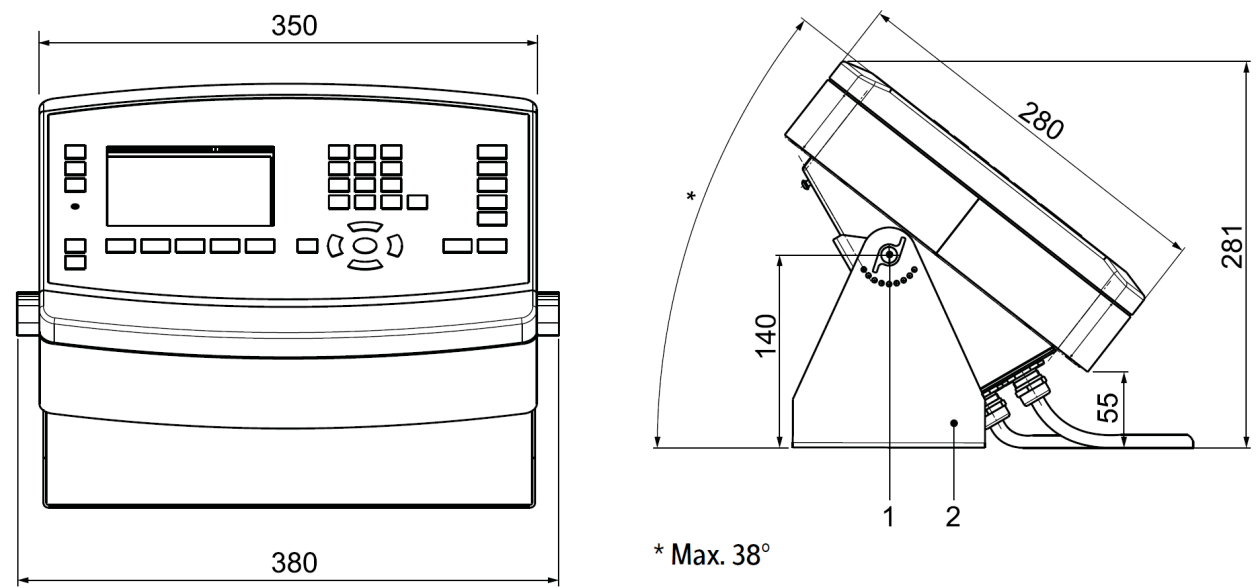

Conveyor belts - Front view

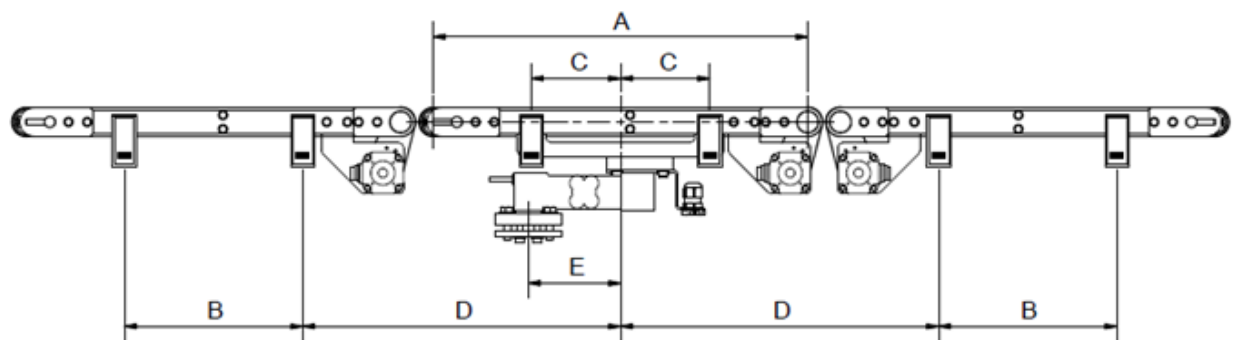

Measurement table

A	B	C	D	E
300	90,5	45,25	289,75	107,5
400	190,5	95,25	339,75	107,5
500	290	145,25	389,75	107,5

Conveyor belts - Side View

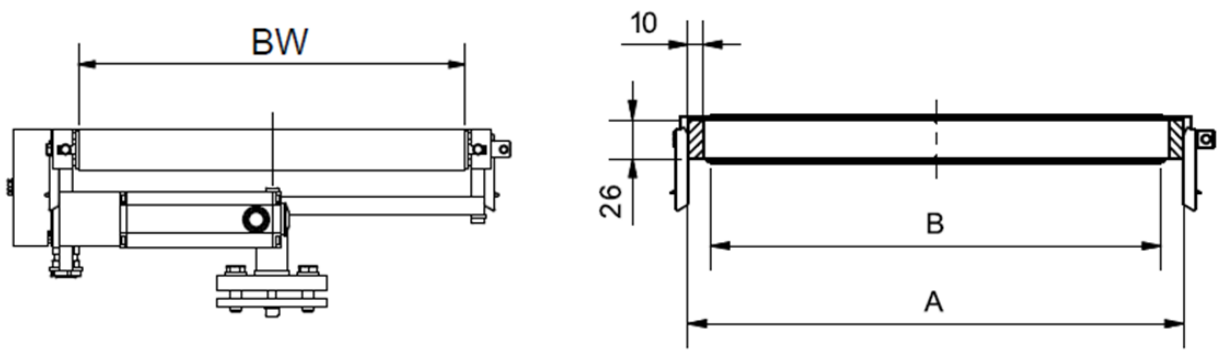

Measurement table

A	B
230	200
330	300

Conveyor belts - Top View

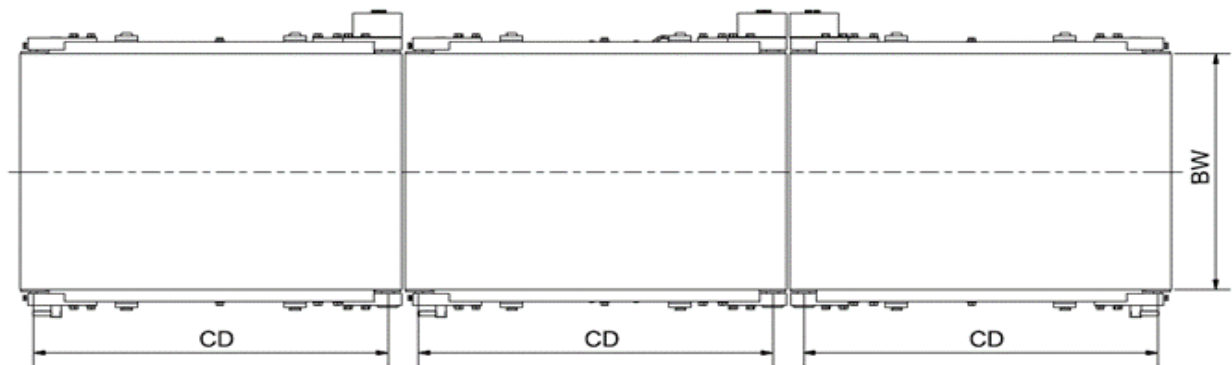

Legend

A, CD	Center-to-center distance
BW, A	Belt width
B, C, D	Center of the clamping units

Options

Strain Gauge OEM Weighing Kit – Equipment

Standard	
Dialog language	German, English, French, Spanish, Italian
Feed direction:	Right to left or left to right
Transport medium infeed, weighing and outfeed	Belt, white
Display	Color-graphic LCD display to show the weigh value, status, bar graph, and dialog / menu text including detailed statistical analyses
Softkeys	Five content-dependent function keys, operational keys for starting, stopping and zeroing, and alphanumeric keypad with "ABC" input
Product memory	100 products
Belt speed	Program-controlled belt speed to optimize the handling for each product
Password protection	2 levels and 1 service
Zero-setting	automatic
Teaching mode	yes (for easy and reliable setting and optimizing of the weighing parameters)
Individual weight data transmission	Serial interface RS232, RS485
Inputs	Light barrier type PNP light-switching (internal function, required hardware is not included in the scope of delivery)
Outputs	1 error (fault); 8 freely configurable digital outputs (eg. belt running)
Operational displays	Product code, name, nominal weight, date/time, single last weighed value, classification (3/5 classes) and distribution into classes (numbers and diagram), mean value, minimum weight, maximum weight, sum weight, accumulated number of (high, OK, low) products, standard deviation, number of ejected products
Auxiliary functions	Dialogs for diagnostics and service, error reports

Options	Software options partly only available after purchase and entering a code, required hardware is not included in the scope of delivery
Field bus data transmission	ProfiNET
Optional inputs	Package length and interval monitoring, external on/off button, compressed air monitoring, rejection monitoring, fill level monitoring, external start/stop signal, hide checkweigher (conveyors keep running), external error input
Optional outputs	e.g. signalling via lamps, horn or control of separator
Logging system	External printer interface RS232 or RS485
Trend controller	3-point controller with control signal; 3-point controller with pulse
USB printing	Reports on USB stick
Check of completeness	with floating average

Ordering information

Ordering options				
Belt dimensions A x B (mm)	Direction of transport	Max Load (g)	Material N° Built-In	Material N° Wall-mounted
300 x 200	Left → Right	600	WKD30X20LR0600BI	WKD30X20LR0600WM
300 x 200	Right → Left	600	WKD30X20RL0600BI	WKD30X20RL0600WM
300 x 200	Left → Right	1200	WKD30X20LR1200BI	WKD30X20LR1200WM
300 x 200	Right → Left	1200	WKD30X20RL1200BI	WKD30X20RL1200WM
300 x 200	Left → Right	3000	WKD30X20LR3000BI	WKD30X20LR3000WM
300 x 200	Right → Left	3000	WKD30X20RL3000BI	WKD30X20RL3000WM
400 x 200	Left → Right	1200	WKD40X20LR1200BI	WKD40X20LR1200WM
400 x 200	Right → Left	1200	WKD40X20RL1200BI	WKD40X20RL1200WM
400 x 300	Left → Right	3000	WKD40X30LR3000BI	WKD40X30LR3000WM
400 x 300	Right → Left	3000	WKD40X30RL3000BI	WKD40X30RL3000WM
400 x 300	Left → Right	6000	WKD40X30LR6000BI	WKD40X30LR6000WM
400 x 300	Right → Left	6000	WKD40X30RL6000BI	WKD40X30RL6000WM
500 x 300	Left → Right	3000	WKD50X30LR3000BI	WKD50X30LR3000WM
500 x 300	Right → Left	3000	WKD50X30RL3000BI	WKD50X30RL3000WM
500 x 300	Left → Right	6000	WKD50X30LR6000BI	WKD50X30LR6000WM
500 x 300	Right → Left	6000	WKD50X30RL6000BI	WKD50X30RL6000WM

The products and solutions presented in this data sheet make major contributions in the following sectors:



Machinery
(OEM)

The technical data given serves as a product description only and should not be understood as guaranteed properties in the legal sense.

Specifications subject to change without notice.
Rev. 11/2021

Minebea Intec Aachen GmbH & Co. KG
Am Gut Wolf 11
52070 Aachen, Germany
Phone +49.241.1827.0
sales.ac@minebea-intec.com
www.minebea-intec.com